Chocolove Building Information

PREPARED BY:



Rare Space Inc.

1331 17th St, M-100
Denver, CO 80202

Tanner Mason

Broker
303-296-8810 (phone)
303-296-8814 (fax)
Mason@rarespace.com

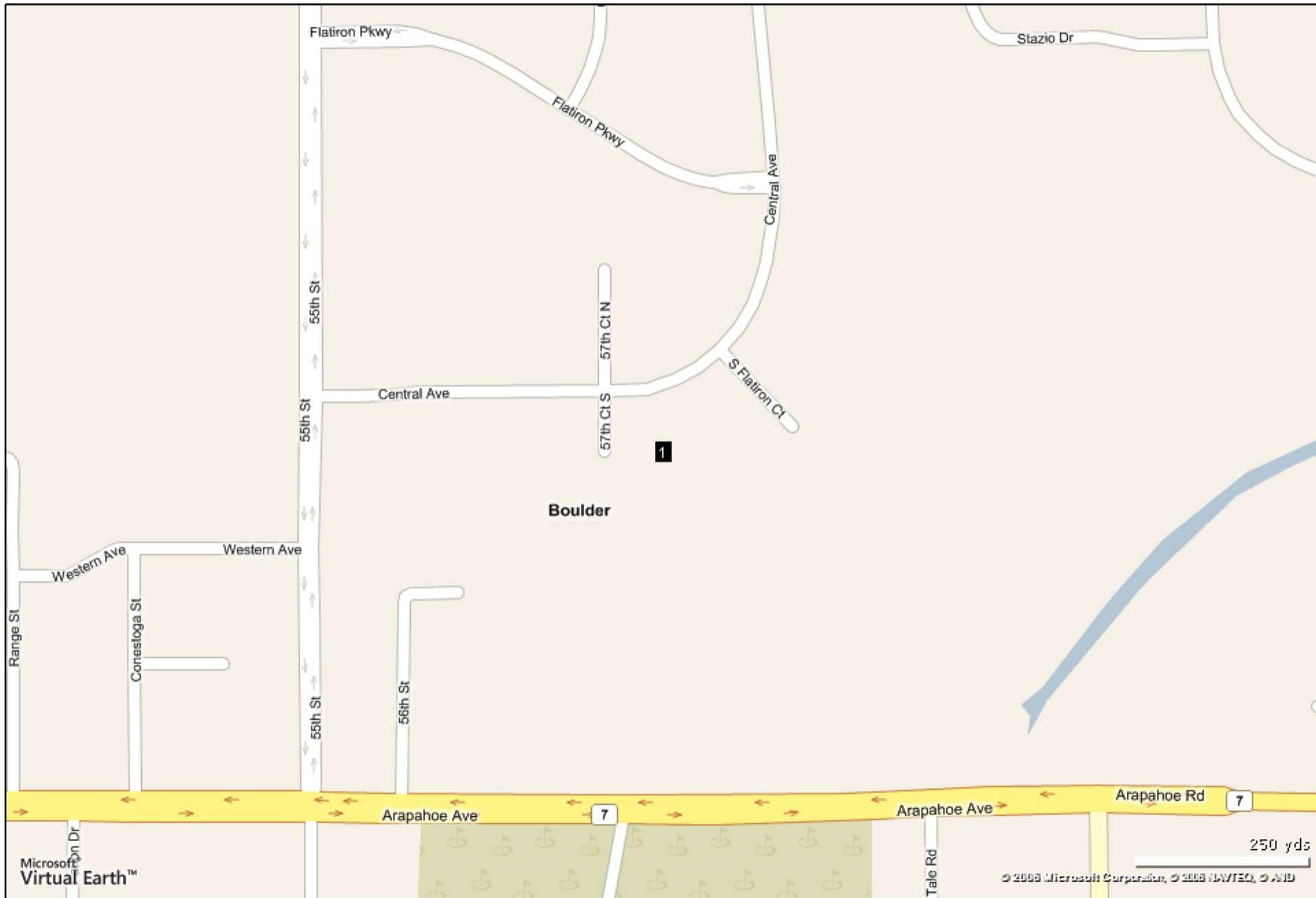

1880 S 57th Ct



Location: **Boulder Ind Cluster**
Boulder Ind Submarket
Boulder County
Boulder, CO 80301

Building Type: **Class B Warehouse**
Status: **Built 1978**
Tenancy: **Multiple Tenant**

Land Area: **4.28 AC**
Stories: **1**
RBA: **80,000 SF**

Management: **Johnson Publishing Company**
Recorded Owner: **Boulder Building Investors Llc**

Total Avail: **No Spaces Currently Available**
% Leased: **100%**

Ceiling Height: **17'5"-19'0"**
Column Spacing: **50'w x 50'd**
Drive Ins: **-**
Loading Docks: **6 ext**
Power: **5000a/208v 3p**

Crane: **None**
Rail Line: **None**
Cross Docks: **-**
Const Mat: **Reinforced Concrete**
Utilities: **-**

Parcel Number: **1463270-03-008**
Parking: **Free Surface Spaces; Ratio of 0.50/1,000 SF**
Amenities: **Property Manager on Site**