Veterans Green Jobs Building Information

PREPARED BY:



Rare Space Inc.

1331 17th St, M-100
Denver, CO 80202

Tanner Mason

Broker
303-296-8810 (phone)
303-296-8814 (fax)
Mason@rarespace.com

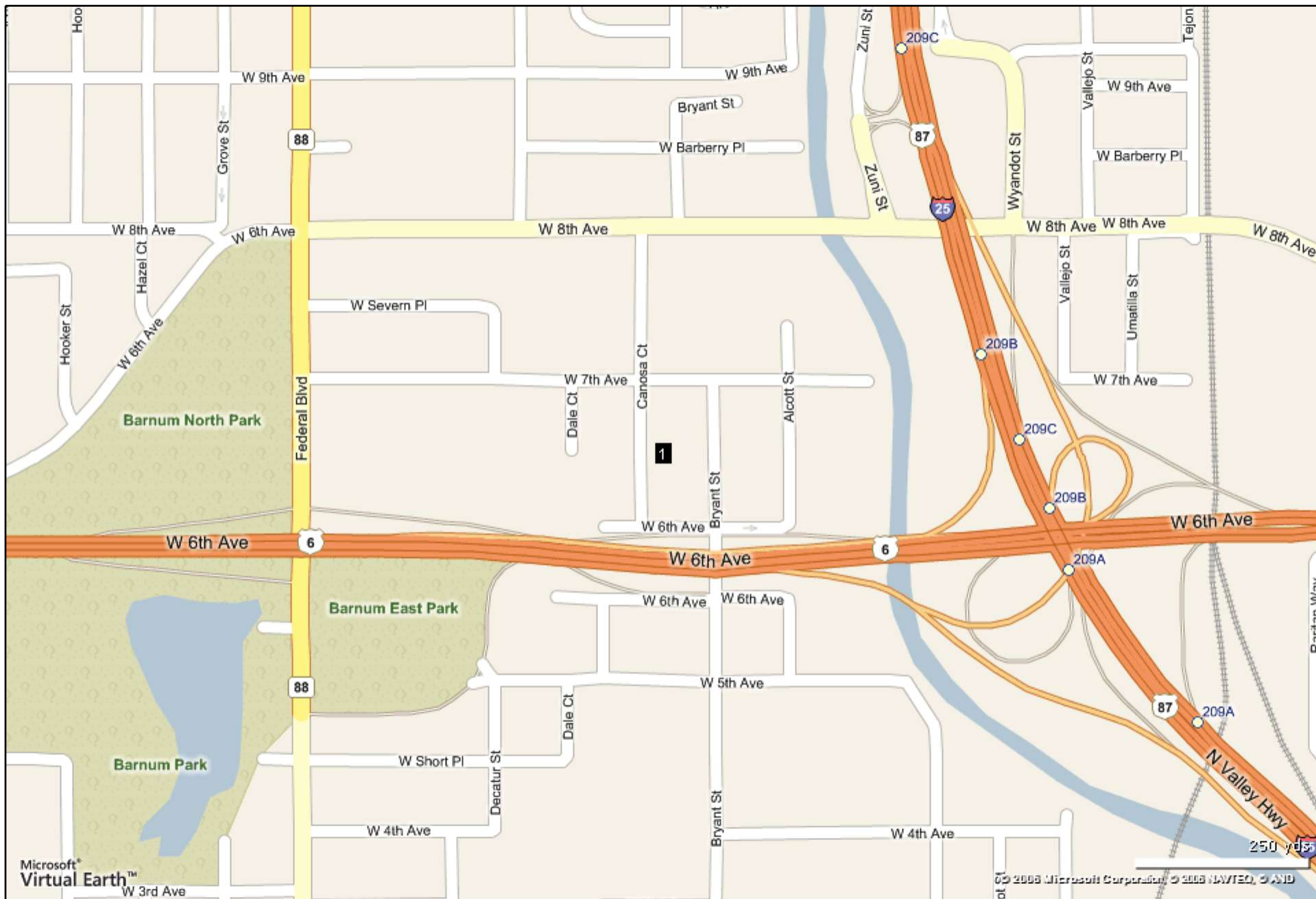

2627 W 6th Ave



Location: **Rexel Ryall Building**
Central Ind Cluster
Mid Central Ind Submarket
Denver County
Denver, CO 80204

Management: **Rexel Ryall Electric Supplies**
Recorded Owner: **Rexel Ryall Electric Supplies**

Ceiling Height: **12'0"-18'0"**
Column Spacing: -
Drive Ins: **2**
Loading Docks: **4 ext**
Power: **1600a/240v 3p**

Expenses: **2008 Tax @ \$0.66/sf**
Parcel Number: **5081-05-024**
Parking: **114 Surface Spaces are available; Ratio of 1.25/1,000 SF**
Amenities: **Fenced Lot, Property Manager on Site**

Building Type: **Class B Warehouse**
Status: **Built 1968**
Tenancy: **Multiple Tenant**

Land Area: **1.72 AC**
Stories: **2**
RBA: **90,870 SF**

Total Avail: **No Spaces Currently Available**
% Leased: **100%**

Crane: -
Rail Line: **None**
Cross Docks: -
Const Mat: **Masonry**
Utilities: -